

212 EAST 98TH STREET

BETWEEN WINTHROP ST & KINGS HWY | BROWNSVILLE



1,900 SF of Prime Retail Space

212 EAST 98TH STREET

BETWEEN WINTHROP ST & KINGS HWY | BROWNSVILLE

PROPERTY HIGHLIGHTS

- Formerly T-Mobile
- High Foot & Vehicle Traffic area
- Great exposure on East 98th Street
- Dense residential neighborhood
- Neighbors include:
Subway, Dunkin', Dollar Tree, C-Town, Dollar General, Golden Krust, Family Dollar, 10 Spot, WOODstack Brooklyn, & many more!

SIZE: 1,900 SF Ground Floor

FRONTAGE: 25'

POSSESSION: Immediate

ASKING RENT: Upon Request

TRANSPORTATION: 2 3 4 5

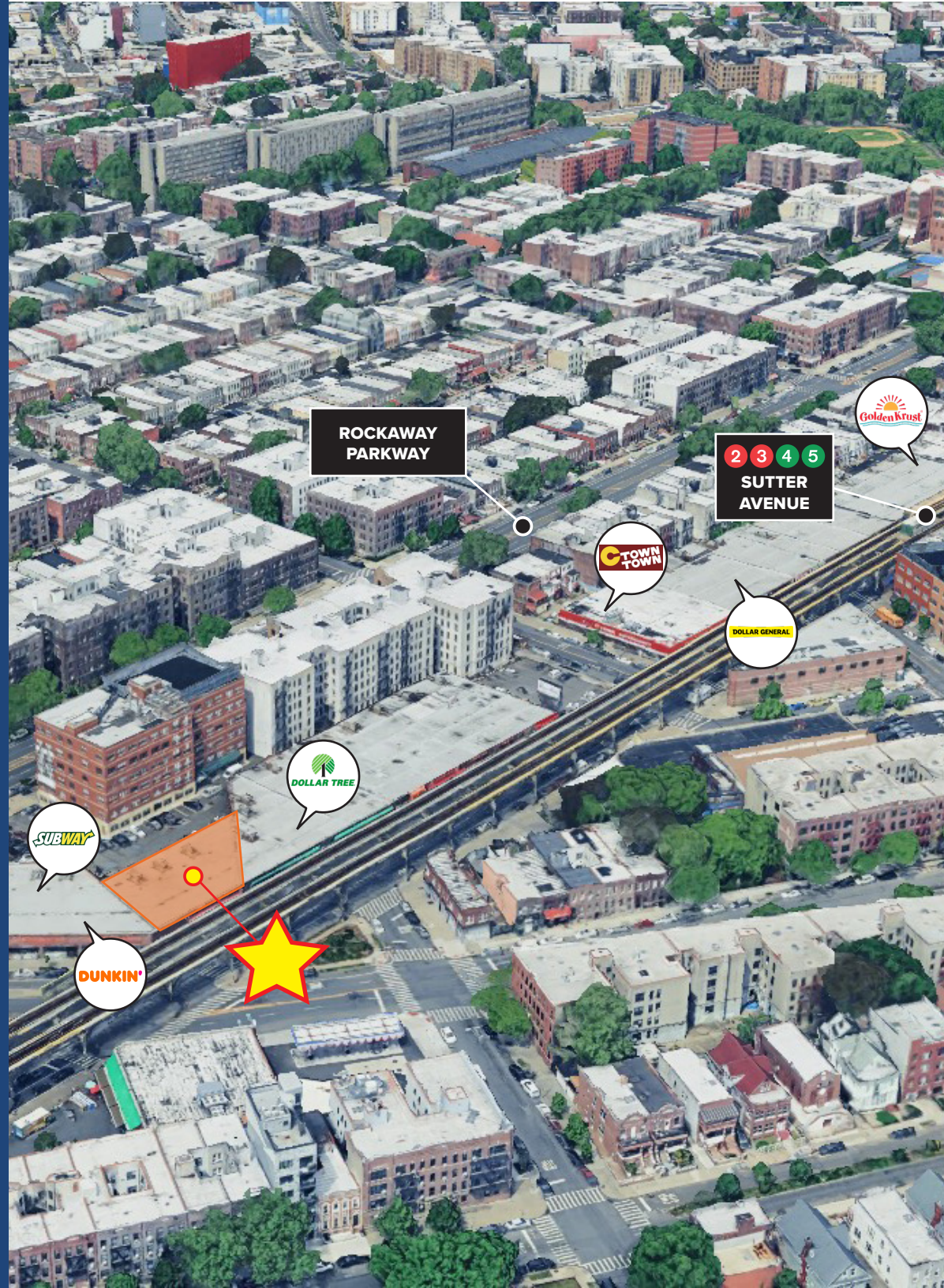

212 EAST 98TH STREET

BETWEEN WINTHROP ST & KINGS HWY | BROWNSVILLE

FLOOR PLANS:
GROUND FLOOR - 1,900 SF

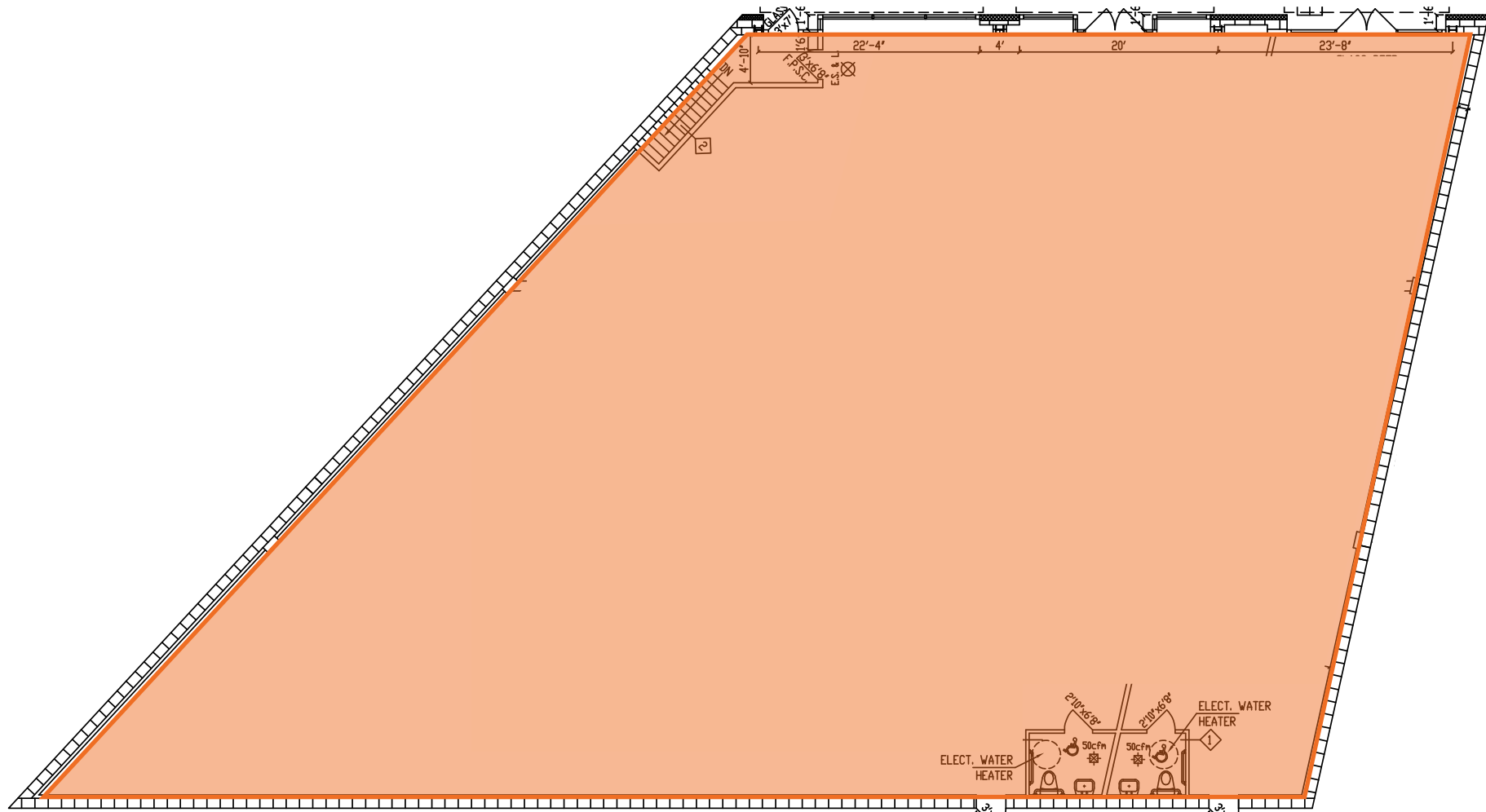

All information supplied in this marketing presentation and/or flyer is from sources deemed reliable and is furnished subject to errors, omissions, modifications, removal of listings from sale/lease and to any listing condition. Any square footage, dimensions, floor plans and/or technical data set forth are approximations and are subject to further elaboration/confirmation.

212 EAST 98TH STREET

BETWEEN WINTHROP ST & KINGS HWY | BROWNSVILLE

FOR MORE INFORMATION,
PLEASE CONTACT:

HUNTER LAZAN

772.559.5195 | HLazan@ksrny.com

JACK KHASKI

917.355.0559 | JackK@ksrny.com

ALBERT MANOPLA

212.380.8369 | AManopla@ksrny.com

