

THE RETAIL AT THE HOTEL ON RIVINGTON

BETWEEN ESSEX & LUDLOW STREETS | AKA 107 RIVINGTON

EXCLUSIVE RETAIL OPPORTUNITY IN THE HEART OF THE LOWER EAST SIDE



107 RIVINGTON

BETWEEN ESSEX & LUDLOW STREETS | LOWER EAST SIDE

SIZE: 2,282 SF Ground Floor
~700 SF Second Floor
2,046 SF Basement

FRONTAGE: ~45'

POSSESSION: ASAP

TRANSPORTATION: J Z F M

HIGHLIGHTS:

- Turnkey restaurant
- Space features:
 - Dining Room & Bar on Ground Floor
 - Lounge space available on Second Floor
 - Kitchen, Storage, Offices in Basement
- Situated at the base of Hotel on Rivington, a 4-star luxury boutique hotel with 100+ rooms
- Neighboring Tenants include: *Tigre Cocktail Bar, Economy Candy, Supermoon Bakehouse, The Magician, La Caverna, Rice to Riches, Kind Regards, Reformation, Frankie Shop, Wildair, Froth New York, Russ and Daughters Cafe, Good Thanks Cafe, Shake Shack, & many more!*



All information supplied in this marketing presentation and/or flyer is from sources deemed reliable and is furnished subject to errors, omissions, modifications, removal of listings from sale/lease and to any listing condition. Any square footage, dimensions, floor plans and/or technical data set forth are approximations and are subject to further elaboration/confirmation.



107 RIVINGTON

BETWEEN ESSEX & LUDLOW STREETS | LOWER EAST SIDE

INTERIORS:
GROUND FLOOR



107 RIVINGTON

BETWEEN ESSEX & LUDLOW STREETS | LOWER EAST SIDE

FLOOR PLANS:
GROUND FLOOR - 2,282 SF

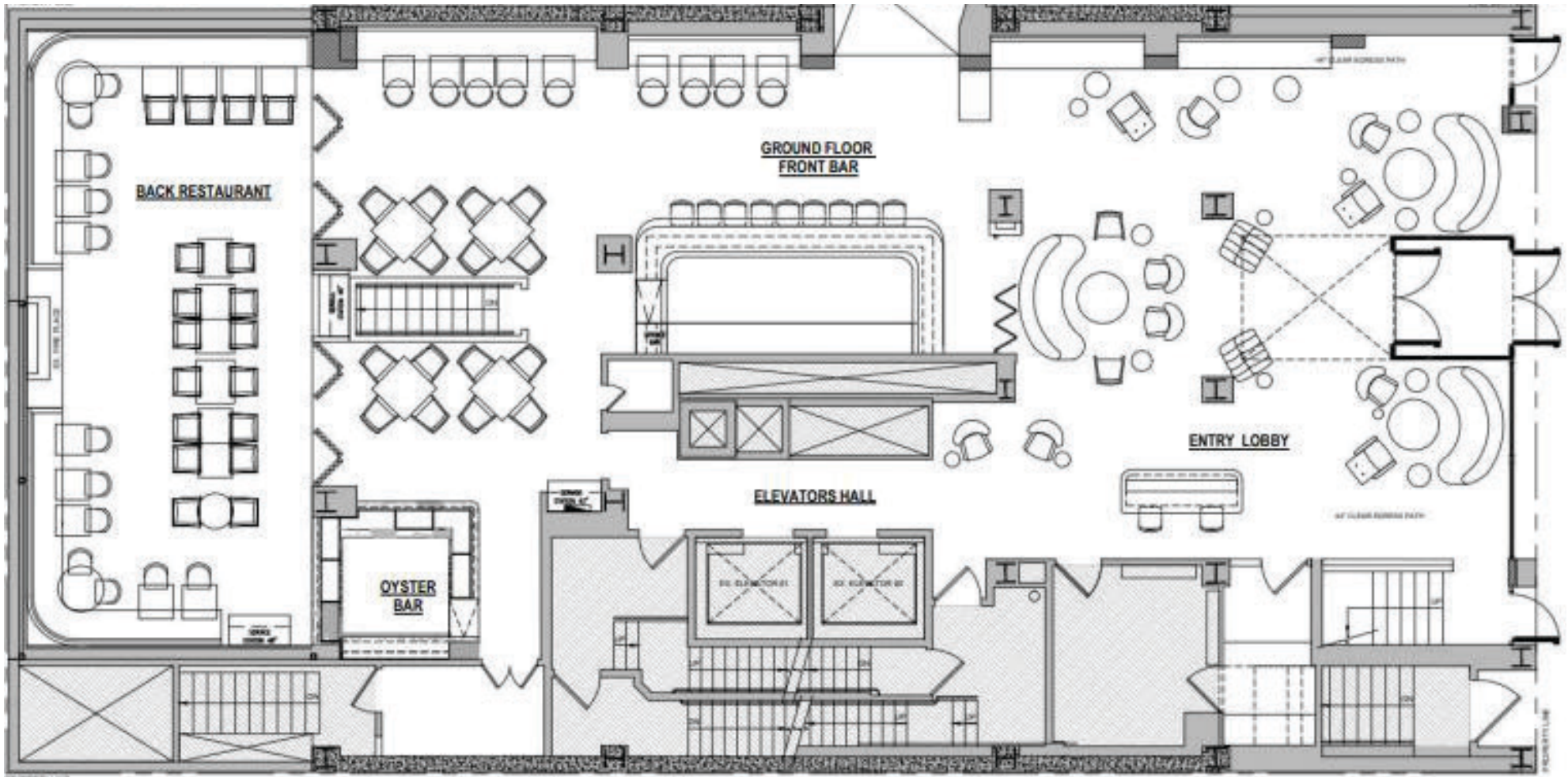

THE
RETAIL AT THE HOTEL ON
RIVINGTON

BETWEEN ESSEX & LUDLOW STREETS | AKA 107 RIVINGTON

FOR MORE INFORMATION,
PLEASE CONTACT:

CAROLINA AZIZ

516.640.6961 | CAziz@ksrny.com

IKE BIBI

347.417.2860 | IBibi@ksrny.com

