

398 Bridge Street

402 Between Fulton & Willoughby St
Downtown Brooklyn

Ground Floor:

Space A - 1,145 SF

Space B - 937 SF

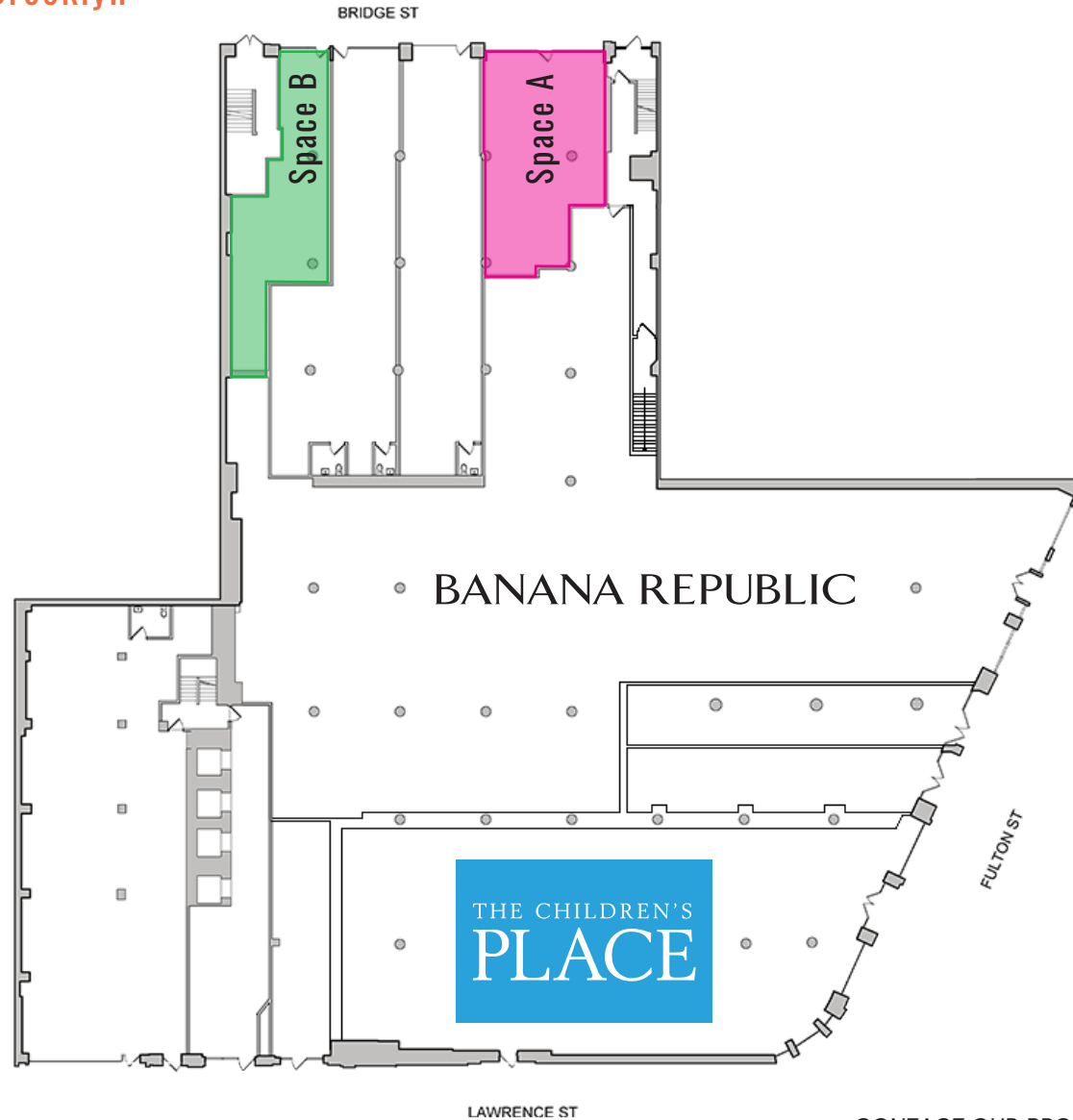

CONTACT OUR BROKERS FOR MORE INFORMATION



All information supplied in this marketing presentation and/or flyer is from sources deemed reliable and is furnished subject to errors, omissions, modifications, removal of listings from sale/lease and to any listing condition. Any square footage, dimensions, floor plans and/or technical data set forth are approximations and are subject to further elaboration/confirmation.

FRED JEMAL
FJemal@ksrny.com
917.359.6359

SOLOMON SHARABY
SSharaby@ksrny.com
718.986.7149

398 Bridge Street

402 Between Fulton & Willoughby St
Downtown Brooklyn

Floor Plan:
2nd Floor/Mezzanine - 7,500 SF

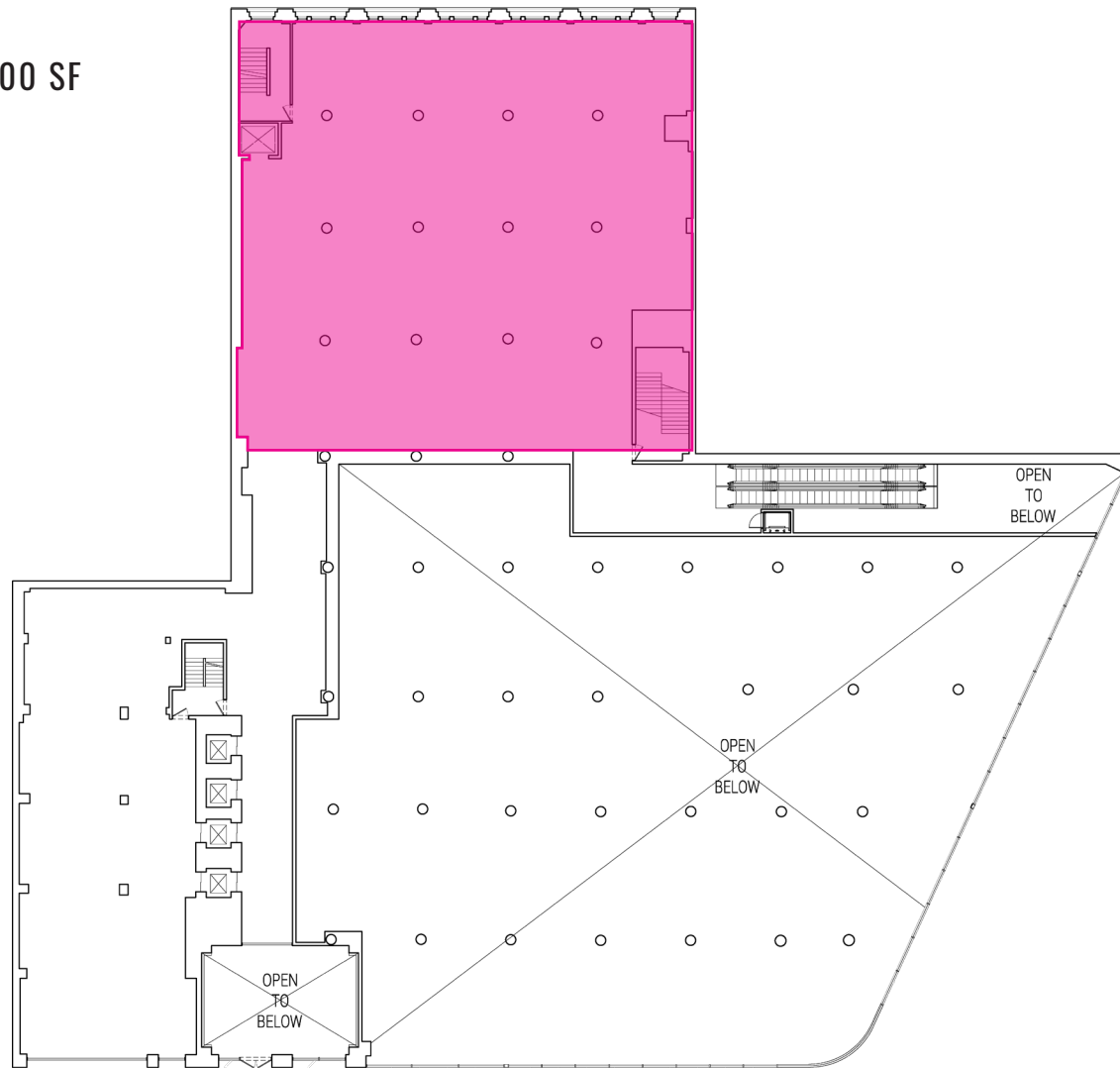

CONTACT OUR BROKERS FOR MORE INFORMATION



All information supplied in this marketing presentation and/or flyer is from sources deemed reliable and is furnished subject to errors, omissions, modifications, removal of listings from sale/lease and to any listing condition. Any square footage, dimensions, floor plans and/or technical data set forth are approximations and are subject to further elaboration/confirmation.

FRED JEMAL
FJemal@ksrny.com
917.359.6359

SOLOMON SHARABY
SSharaby@ksrny.com
718.986.7149