

89 WASHINGTON STREET

OFF THE CORNER OF RECTOR & WASHINGTON STREETS | FIDI



SPACE B



LEASED

89 WASHINGTON STREET

OFF THE CORNER OF RECTOR & WASHINGTON STREETS | FIDI

PROPERTY DETAILS

SPACE A:	1,461 SF Ground Floor	LEASED
SPACE B:	550 SF Ground Floor	
FRONTAGE:	A: 20' B:10'	
CEILING HEIGHT:	12'	
POSSESSION:	Immediate	
TRANSPORTATION:	1 2 4 5 R W	

HIGHLIGHTS

- Space A: leased to *Pilates Social Club*
- Situated at the base of luxury condo building with 450 units
- Connected to the Greenwich Club Residences
- Adjacent to world-renowned architect Rafael Vinoly's latest masterpiece and supretall residential tower, The Greenwich, with 272 units
- Surrounded by multiple subway lines including The Fulton Center and World Trade Center transportation hubs
- Within walking distance to global fashion labels, indoor malls (*Brookfield Place, Westfield, South Street Seaport*), and food halls
- Neighboring tenants:



89 WASHINGTON STREET

OFF THE CORNER OF RECTOR & WASHINGTON STREETS | FIDI

FLOOR PLANS:

SPACE A - 1,400 SF GROUND FLOOR **LEASED**

SPACE B - 500 SF GROUND FLOOR

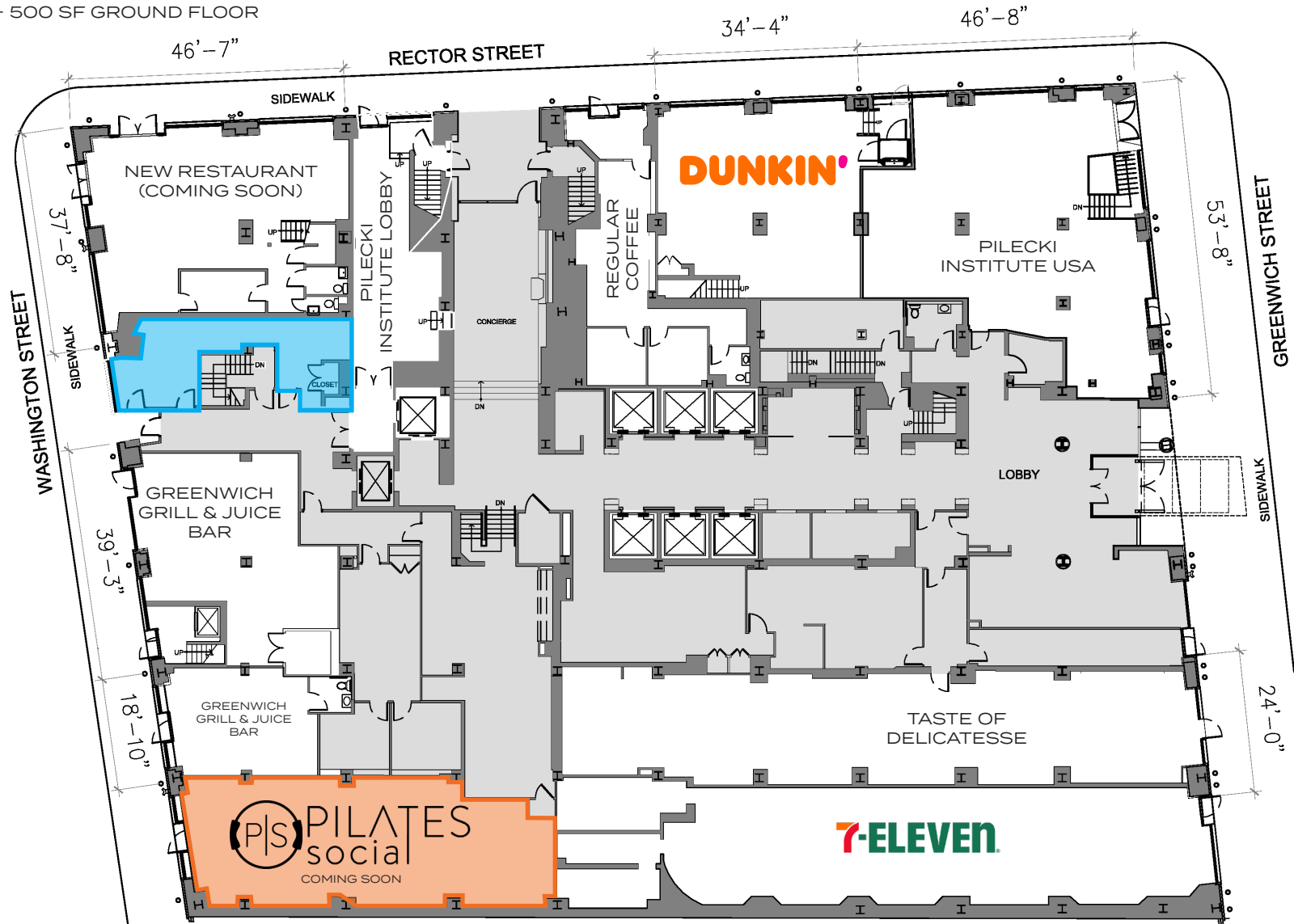

FOR MORE INFORMATION, PLEASE CONTACT:

SOPHIA GAINES

M: 917.902.6352
SGaines@ksrny.com

ALBERT J. MANOPLA

M: 212.380.8369
AManopla@ksrny.com

SAM SABIN

M: 917.846.5367
SSabin@ksrny.com



1385 Broadway
New York, NY 10018
212.417.9217 | ksrny.com

