

# 3225 THIRD AVENUE

CORNER OF 163RD STREET & 3RD AVENUE | MELROSE

PREMIER RETAIL SPACE AVAILABLE



Over 7,500 SF  
Premier Retail Space  
Available for Lease

DUNKIN'

JJ JIMMY JOHN'S

BASKIN BR ROBBINS

PARK

# 3225 THIRD AVENUE

CORNER OF 163RD STREET & 3RD AVENUE | MELROSE

## PROPERTY HIGHLIGHTS

- Former Duane Reade
- Heavy foot traffic area
- Adjacent to Bx6, Bx15, & Bx21 bus stops
- Short walk from Prospect Avenue subway station
- Neighbors include:  
*Jimmy Johns, Dunkin, Subway, Popeyes, Metro by T-Mobile, Kennedy Fried Chicken, C-Town Supermarket, Panda Express, & many more!*

**SIZE:** 7,500 SF Ground Floor

**FRONTAGE:** 80'

**CEILING HEIGHT:** 10'+

**POSSESSION:** Arranged

**ASKING RENT:** Upon Request

**TRANSPORTATION:**  



# 3225 THIRD AVENUE

CORNER OF 163RD STREET & 3RD AVENUE | MELROSE

FLOOR PLANS:  
GROUND FLOOR - 7,500 SF

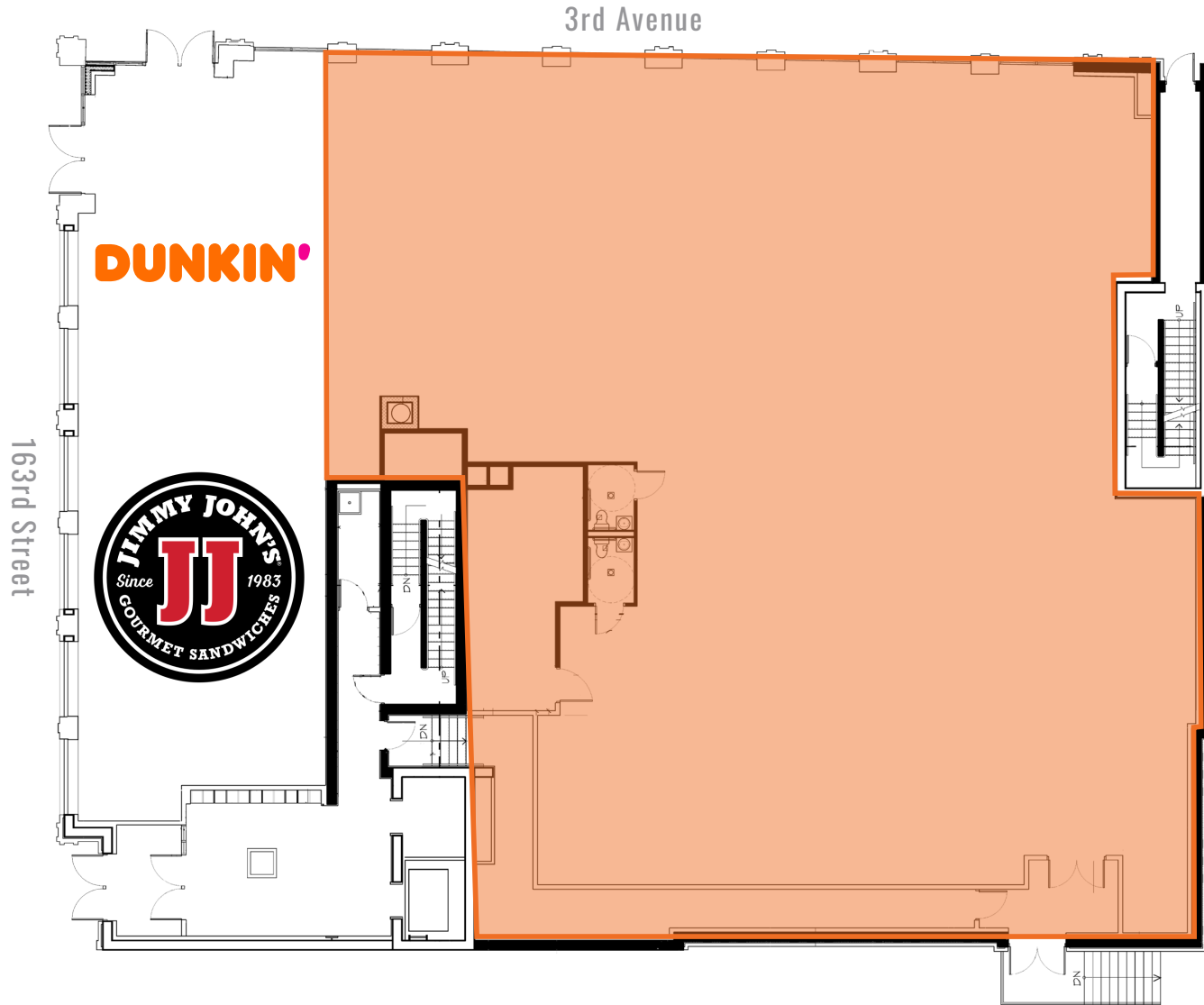

# 3225 THIRD AVENUE

CORNER OF 163RD STREET & 3RD AVENUE | MELROSE

FOR MORE INFORMATION,  
PLEASE CONTACT:

**RAFI BENOR**

347.459.0445 | [RBenor@ksrny.com](mailto:RBenor@ksrny.com)

**EZRA FALACK**

718.415.0095 | [EFalack@ksrny.com](mailto:EFalack@ksrny.com)

**SOLOMON SHARABY**

718.986.7149 | [SSharaby@ksrny.com](mailto:SSharaby@ksrny.com)

