

502

86TH STREET

CORNER OF 86TH ST & 5TH AVE | BAY RIDGE

Floor Plans:
Ground Floor - 7,500 SF (existing condition)

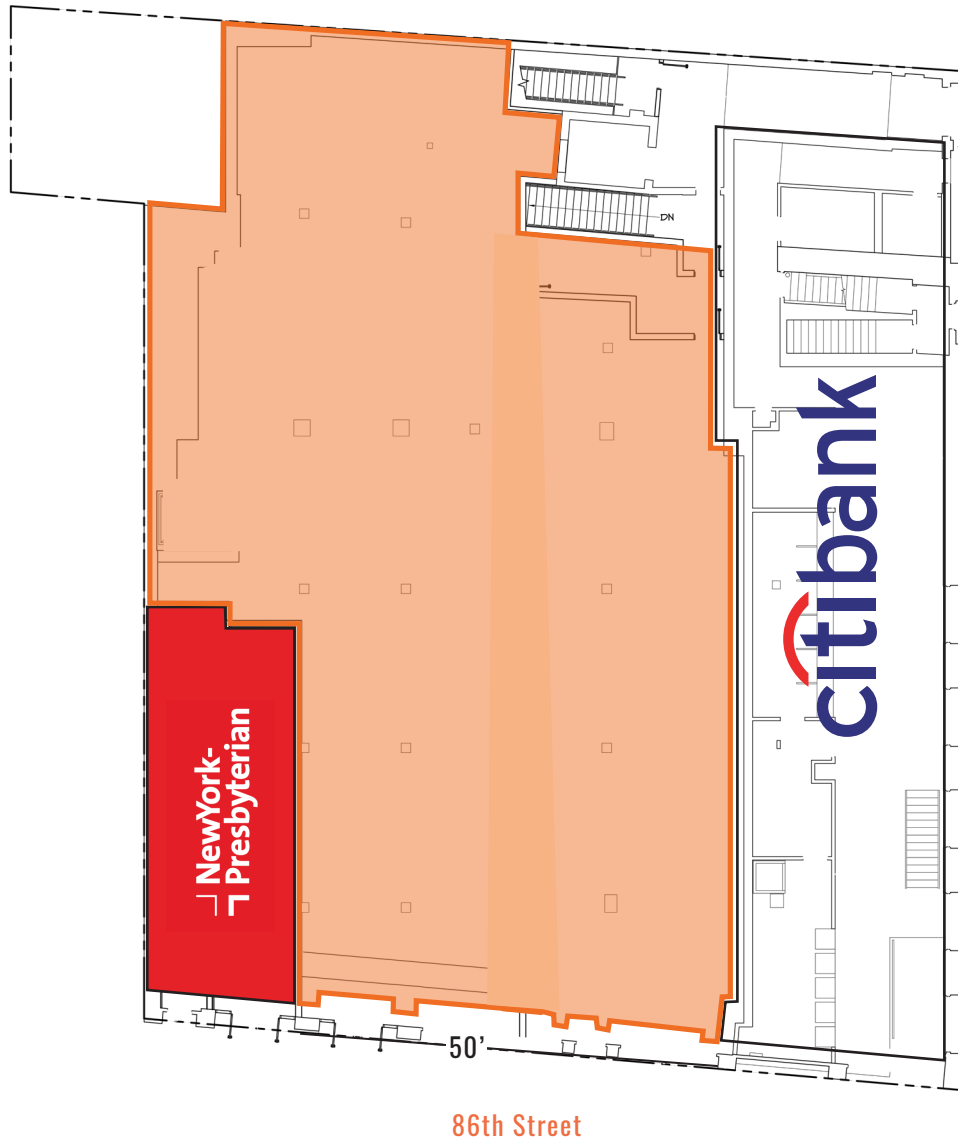

Ground Floor - Potential Divisions

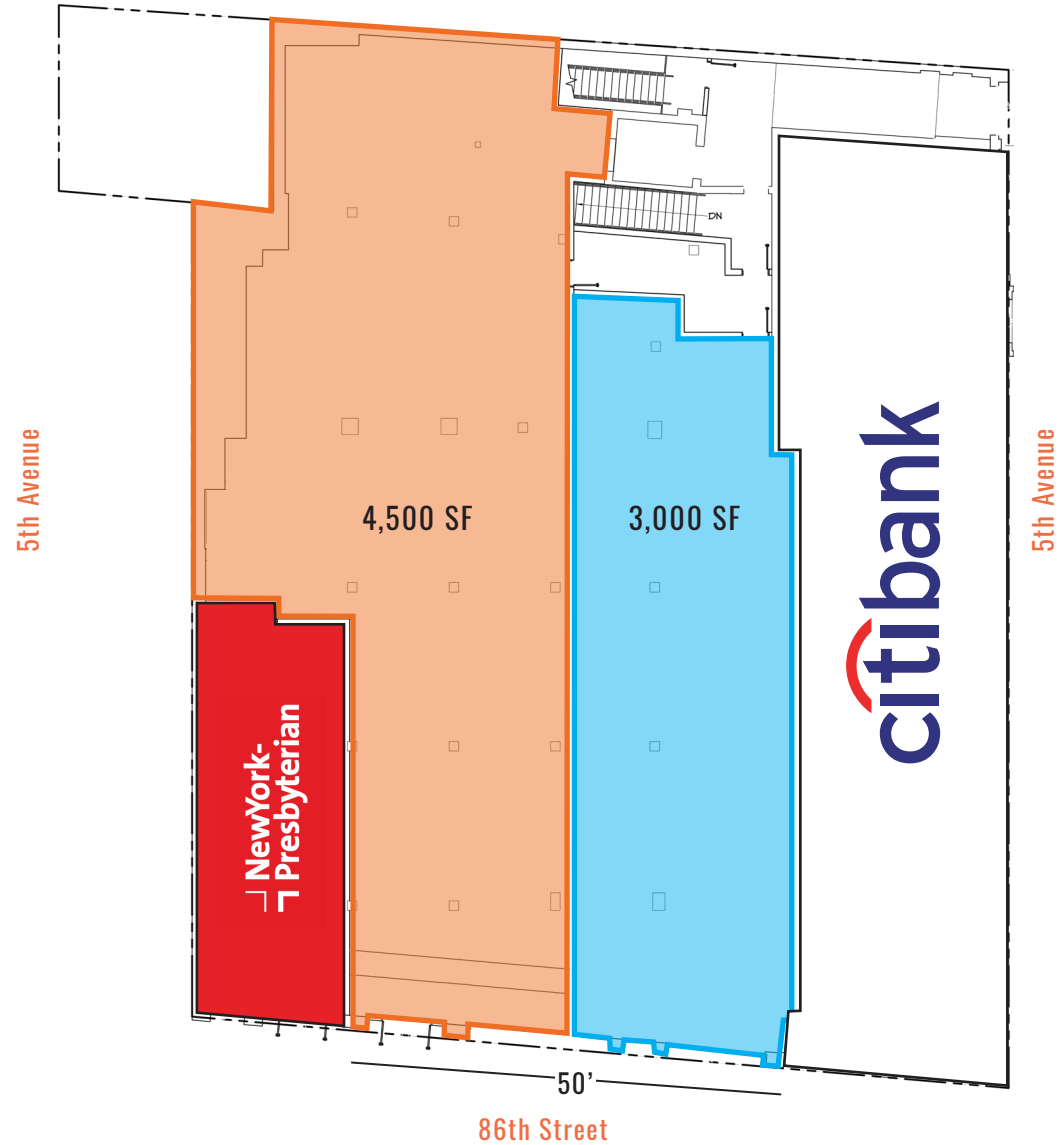

502

86TH STREET

CORNER OF 86TH ST & 5TH AVE | BAY RIDGE

Floor Plans:
Lower Level - 8,500 SF

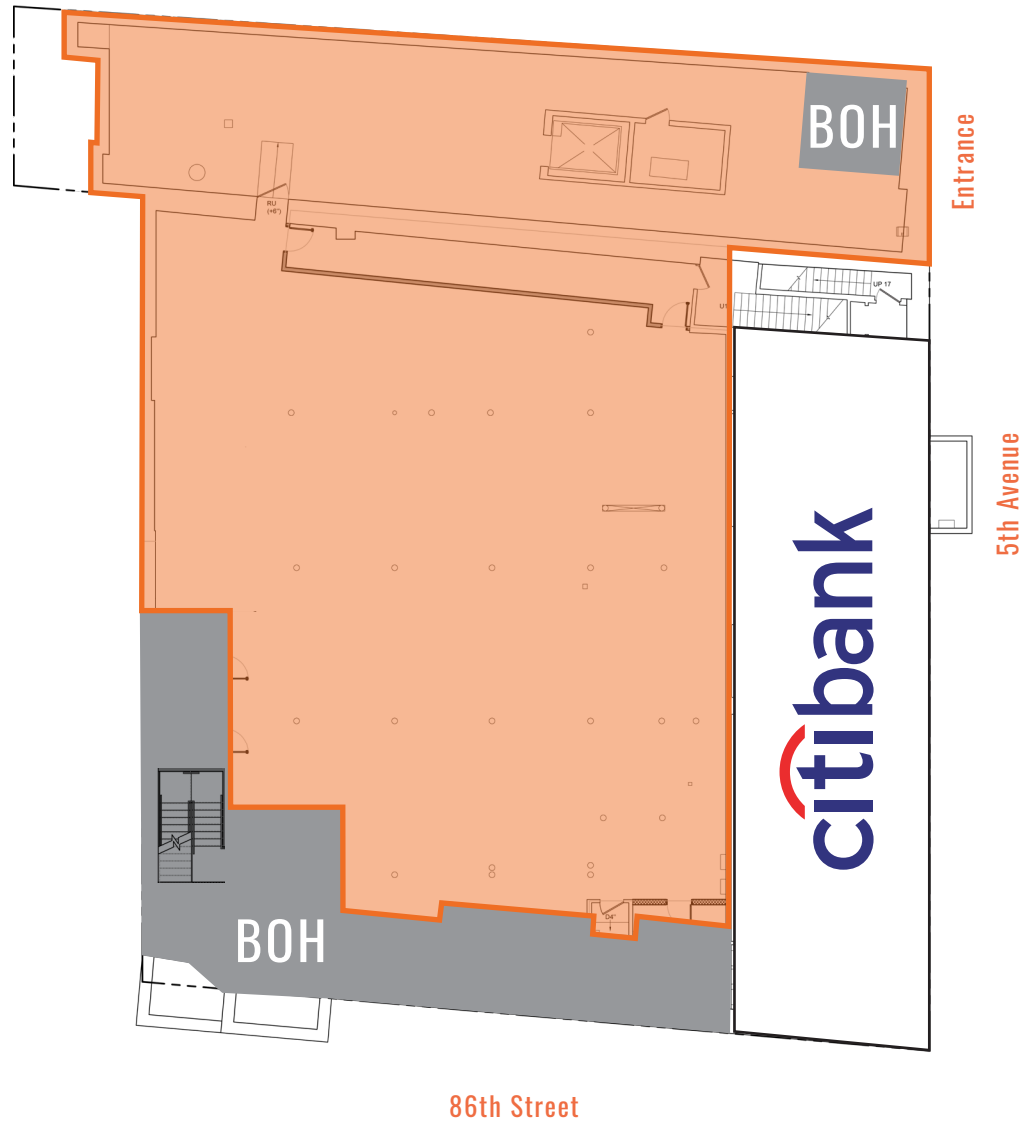

All information supplied in this marketing presentation and/or flyer is from sources deemed reliable and is furnished subject to errors, omissions, modifications, removal of listings from sale/lease and to any listing condition. Any square footage, dimensions, floor plans and/or technical data set forth are approximations and are subject to further elaboration/confirmation.