



2551A BROADWAY

UPPER WEST SIDE

2551A BROADWAY

Between 95th & 96th Streets | Upper West Side

PROPERTY INFORMATION:

SIZE: 1,963 SF Ground Floor

FRONTAGE: 40'

POSSESSION: ASAP

TRANSPORTATION: 1 2 3

HIGHLIGHTS:

- Located at the base of a newly built, 131-unit luxury condominium building
- 400 AMPS electrical available
- Adjacent to the 96th St subway station, servicing approximately 11,700,000 riders annually
- **Neighbors include:** *StretchLab, Citibank, Spectrum, Chipotle, Housing Works, Van Leeuwen, NY Sports Club, Paris Baguette, Starbucks, Pinkberry, Subway, Village Square Pizza, Westside Market, & More!*

CONTACT OUR BROKERS FOR MORE INFORMATION:

CAROLINA AZIZ
CAziz@ksrny.com
516.640.6961

IKE BIBI
IBibi@ksrny.com
347.417.2860

MICHAEL BIJOU
MBijou@ksrny.com
646.648.0248

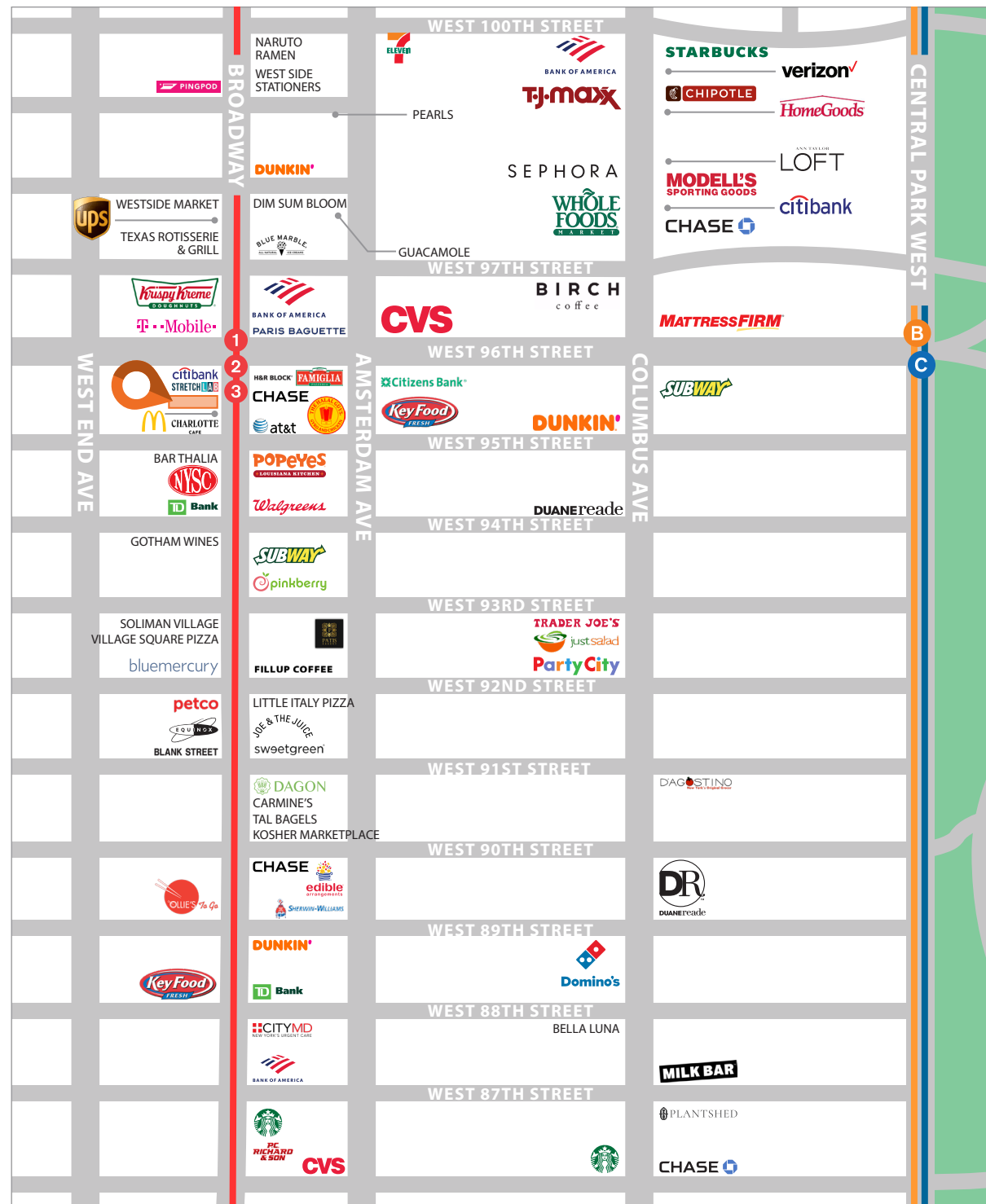

All information supplied in this marketing presentation and/or flyer is from sources deemed reliable and is furnished subject to errors, omissions, modifications, removal of listings from sale/lease and to any listing condition. Any square footage, dimensions, floor plans and/or technical data set forth are approximations and are subject to further elaboration/confirmation.

2551A BROADWAY

Between 95th & 96th Streets | Upper West Side

FLOOR PLANS:

GROUND FLOOR - 1,963 SF

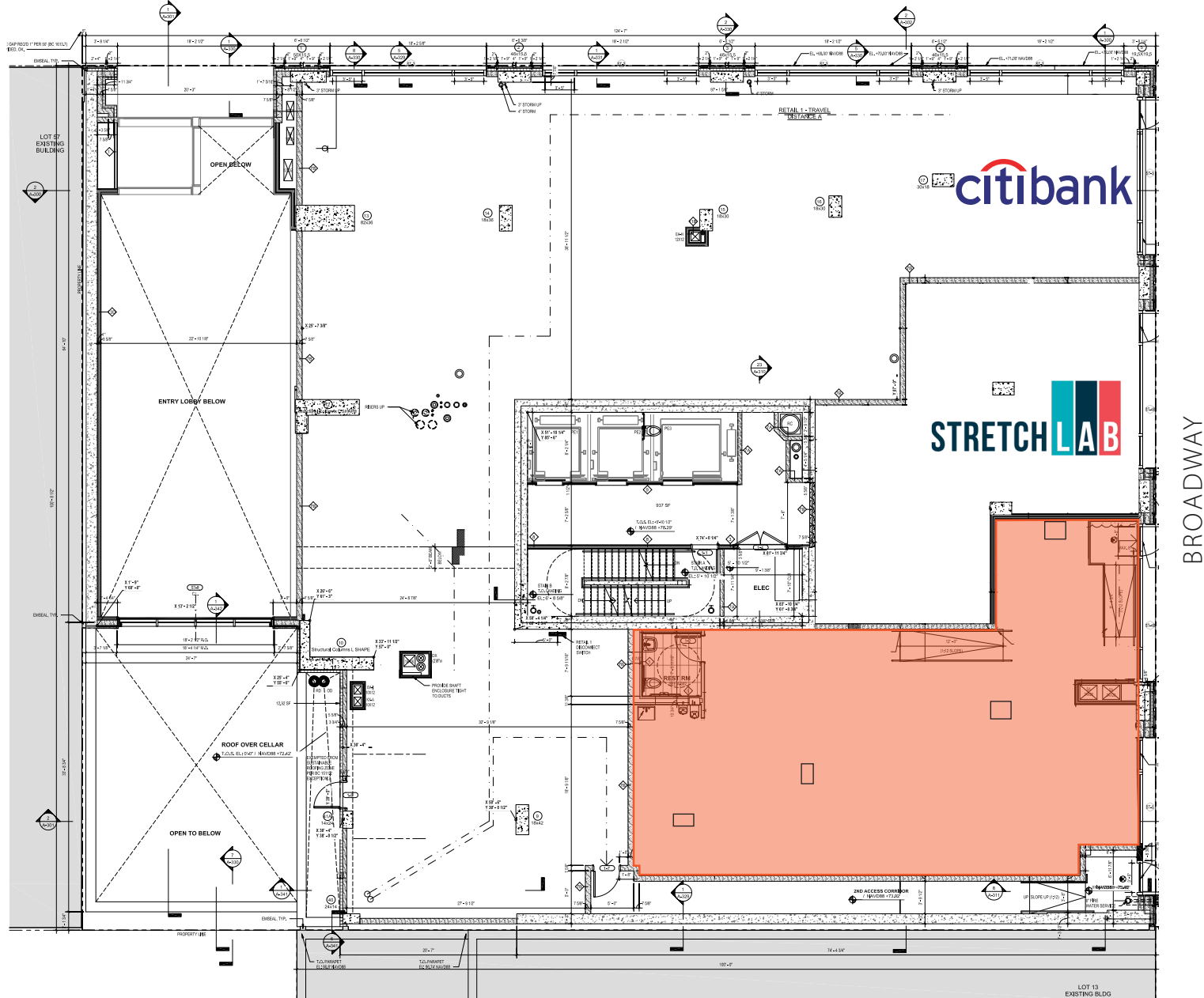

All information supplied in this marketing presentation and/or flyer is from sources deemed reliable and is furnished subject to errors, omissions, modifications, removal of listings from sale/lease and to any listing condition. Any square footage, dimensions, floor plans and/or technical data set forth are approximations and are subject to further elaboration/confirmation.

2551A BROADWAY

Between 95th & 96th Streets | Upper West Side

INTERIORS:

